

February 27, 2019

2/27/19 695 Sporting Club Drive
1st floor

Living R	19'x24'	- 456' sq
Kitchen/Dining	16'x25'	- 400' sq
Sitting R	16'x9'	- 144' sq
Living R	19'x12'	- 228' sq
Master Bed R	16'x19'	- 304' sq
Bath ①		- 157' sq
Bath ②		- 95' sq
Bath ③	5'x7.5'	- 37' sq
Bath ④	5'x3'	- 15' sq
Bath ⑤	5'x6'+12'	- 42' sq

2nd floor

Bed R above garage	14'x20.5'+24'+15'	- 326' sq
Bed R ①	19'x15.5'+60'	- 354' sq
Bed R ②	13'x16'	- 208' sq
Bed R ③	16'x15.5'+60'	- 308' sq
Bath R ①	16'x6'+45'+9'	- 150' sq
Bath R ②	3.5'x6.5'+12'	- 35' sq
Bath R ③	16'x6'+49'	- 145' sq
Garage	23'x25'	- 575' sq

1st floor living space	-	2,775' sq
2nd floor living space	-	1,680' sq
Total living space	-	4,455' sq

2/21/19 673 Sporting Club Wye

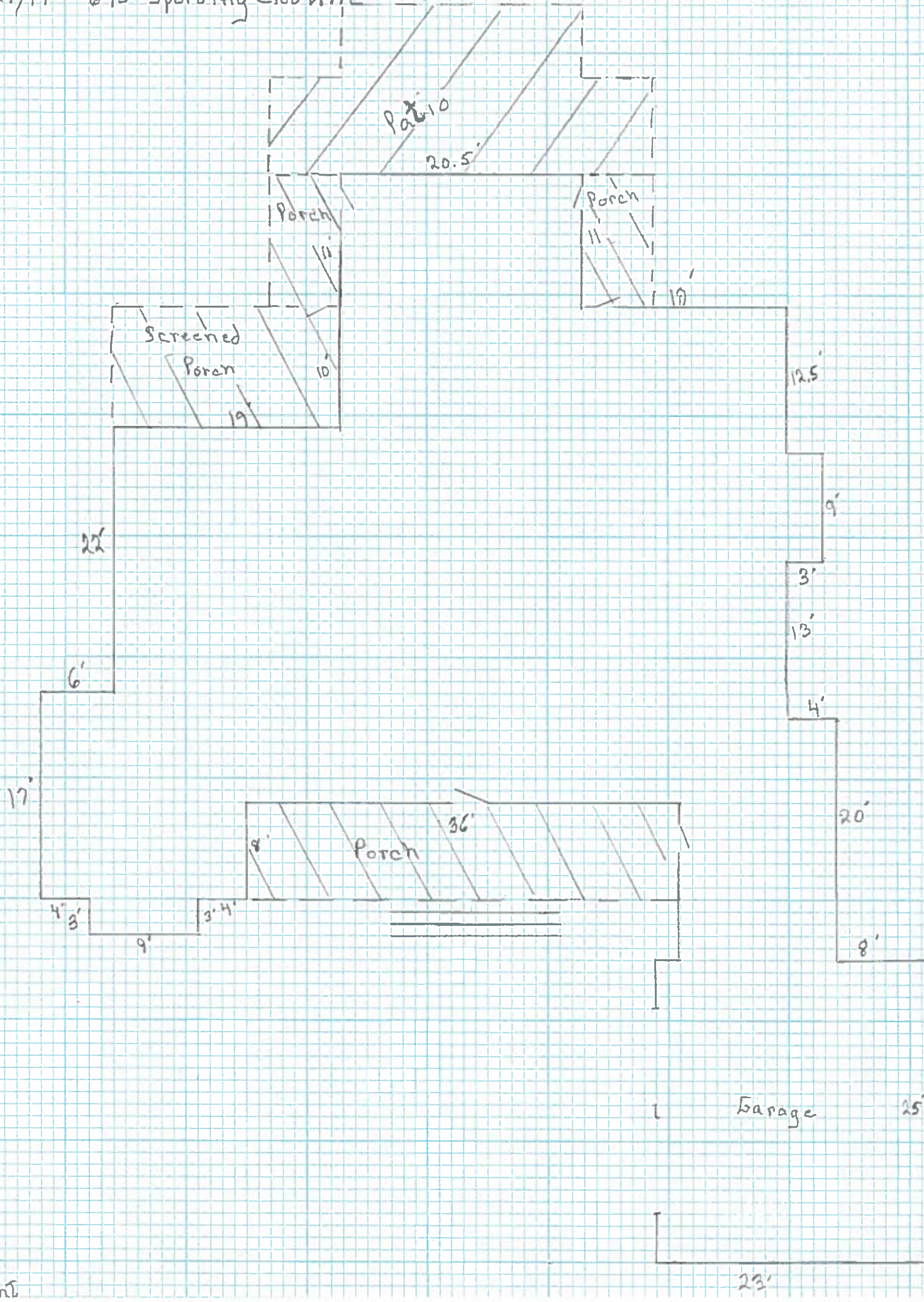

2/22/19

Front

23'

2/21/17 612 Sporking - Lub VIVE

1st floor

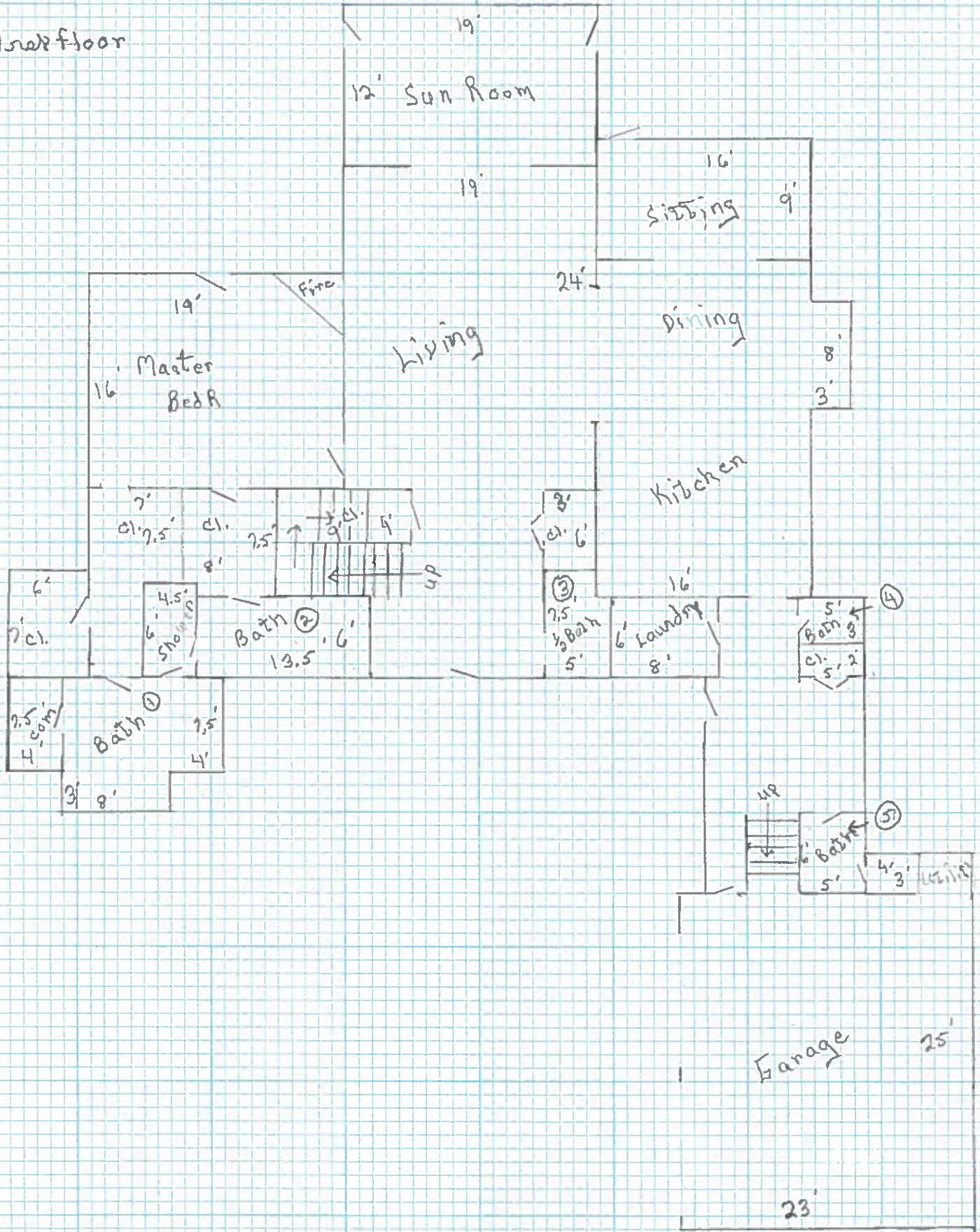

Bed R. above garage

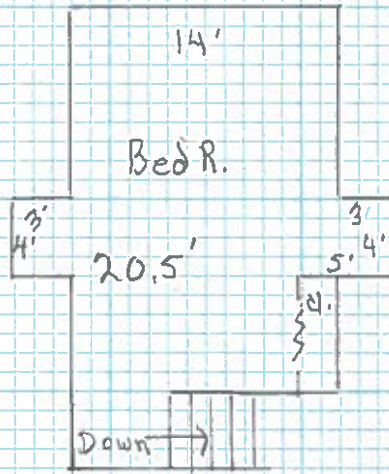

2nd floor

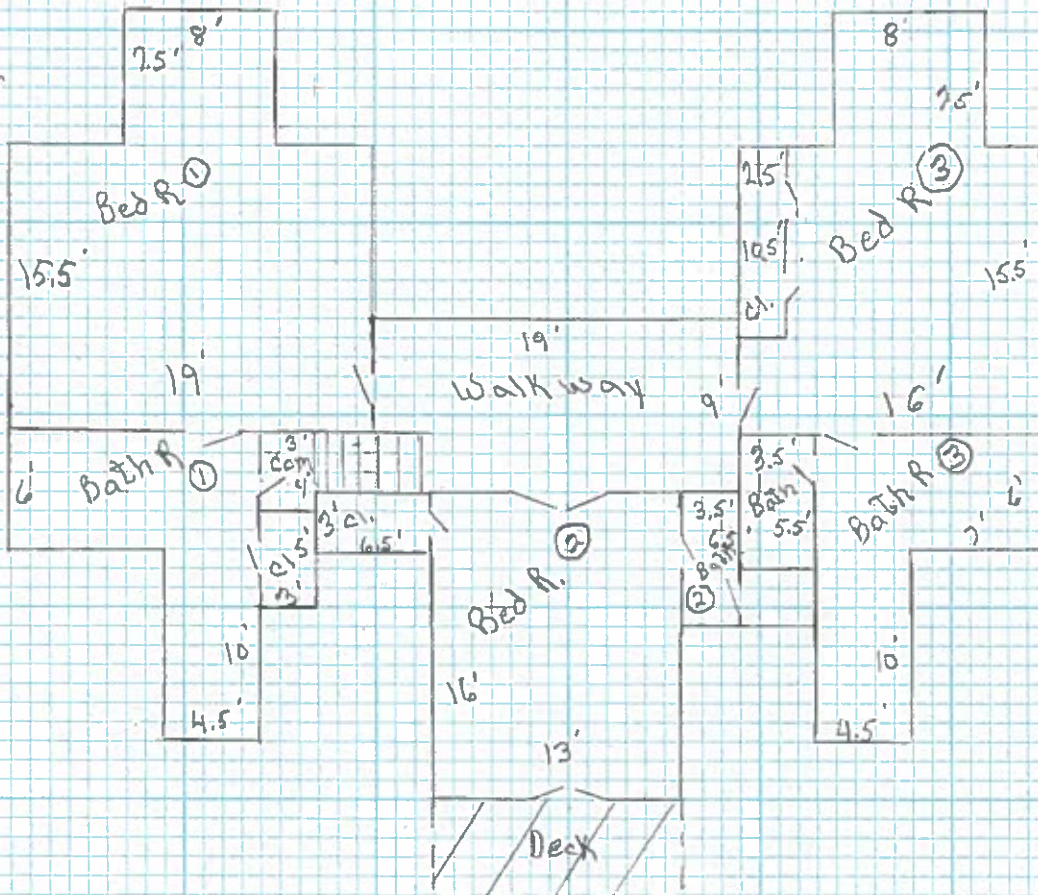

Front